

SANTRO Element Assembly instruction

Mount wall rail

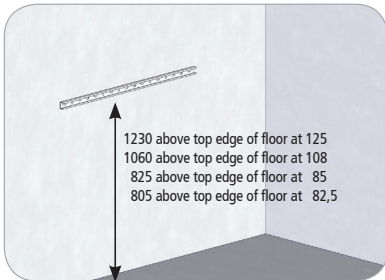

Lock the bolt on the U-profile

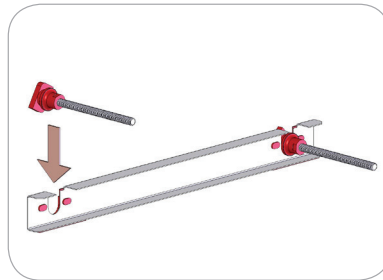

Place on wall rail

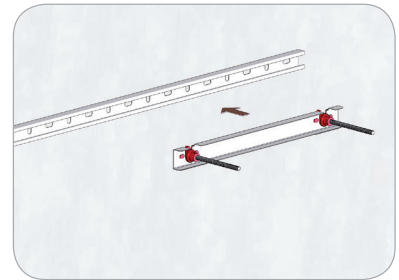

Tighten with open-end spanner

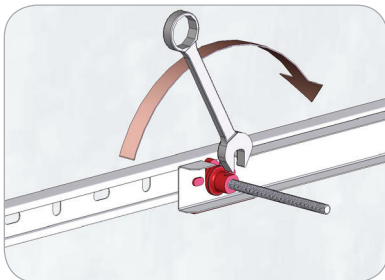

Insert foot plates, adjust

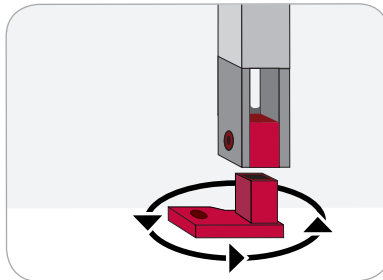

Foot plates outside

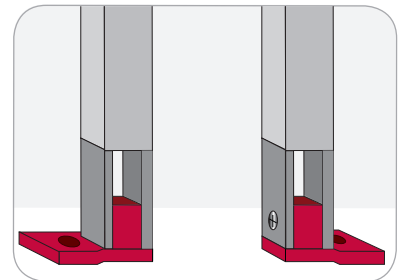

Front foot plates

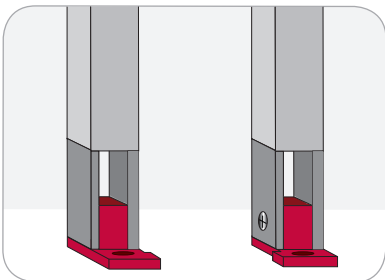

or foot plates inside

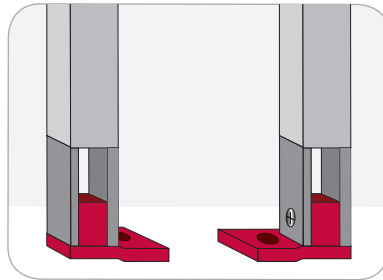

and screw tight

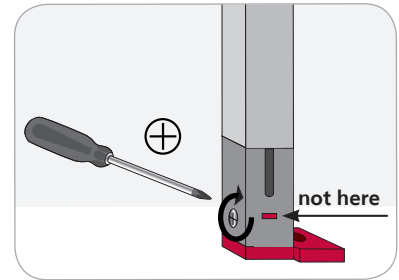

Loosen screw on outer profile

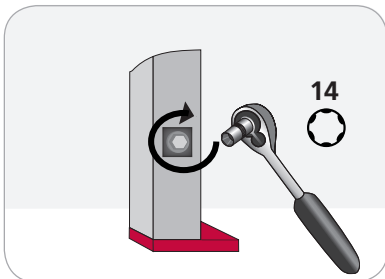

Adjusting the height

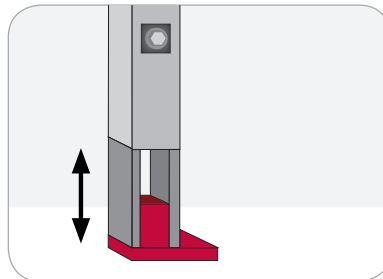

Slide the module onto the bolt

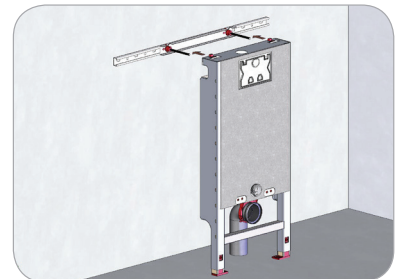

and align in depth

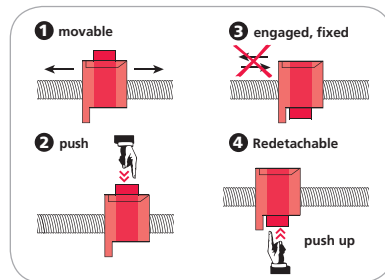
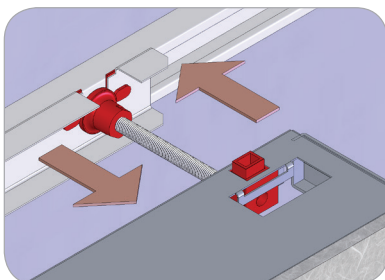

Engage and anchor foot area

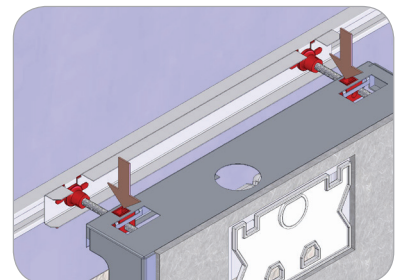

After mounting the WC bolts, lock them with the enclosed 12 mm nut.