

Installation instructions BS+ WC

Mounting on the pre-wall

To produce the planking support can be installed with UW drywall profiles profiles by simply plugging them on.

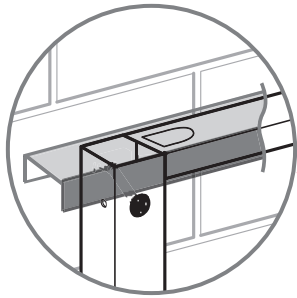

Fastening bolts according to the dimensions of the ceramic manufacturer and lock with the enclosed 12 mm nuts.

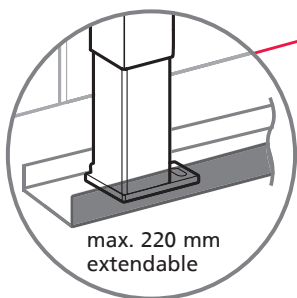
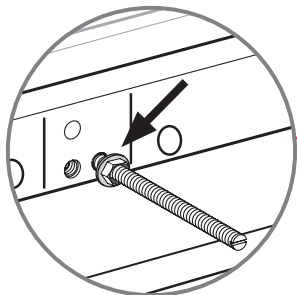

Use of a UW drywall profile as a floor rail facilitates the professional drywall panelling.

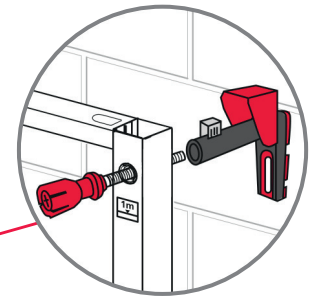
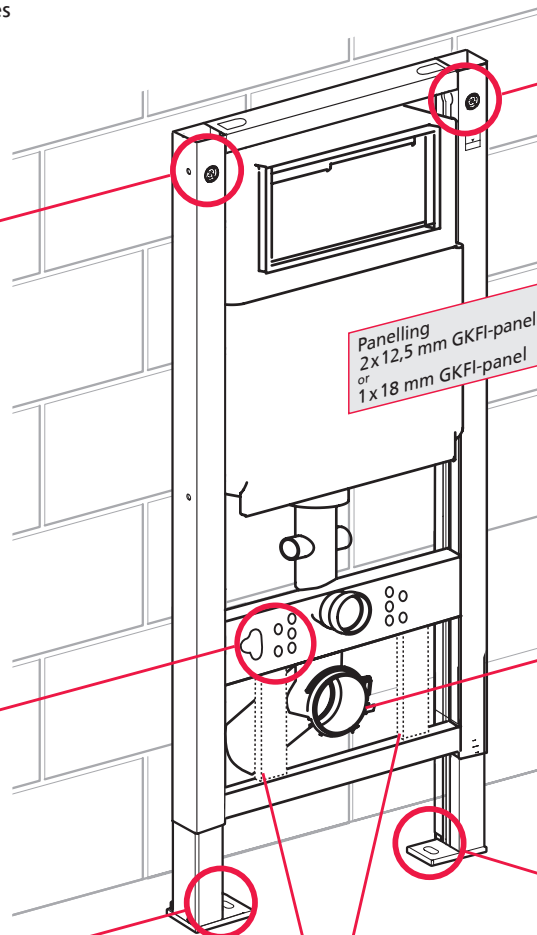

Push the threaded rod through the drill hole into the wall bracket until it clicks, align the depth of the wall bracket and secure with the clamp.

ATTENTION: New clamp mounting

First attach the clamp to the drain pipe, then snap into the abutment

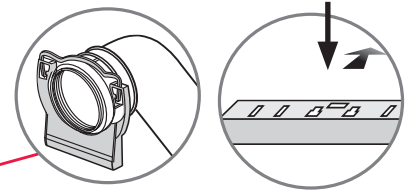

Use a 13 mm spanner to fasten

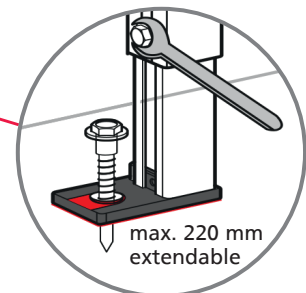

Note: Before fitting the element to the corresponding dimensions of the ceramic manufacturer before installation.

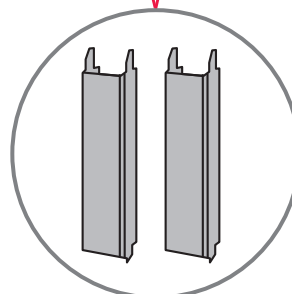

Important note!

WC power bearing for WC ceramics with a support surface smaller than 17 cm, for installation between the traverses item.-no. 216 400

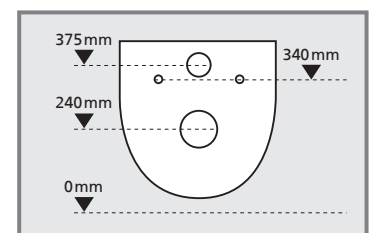

Installation instructions BS+ WC

Mounting in the stud wall

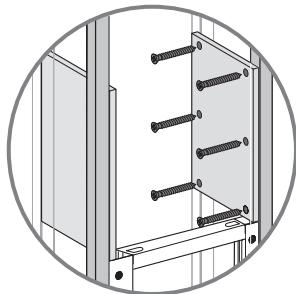

Insert stabilising plates

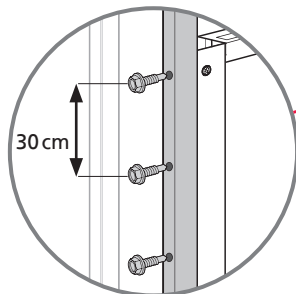

Screw the mounting element to the vertical drywall profiles.

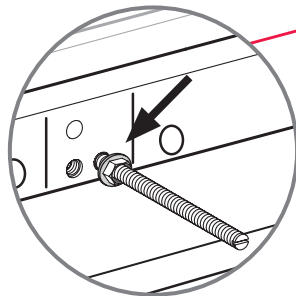

Fastening bolts according to the dimensions of the ceramic manufacturer and lock with the enclosed 12 mm nuts.

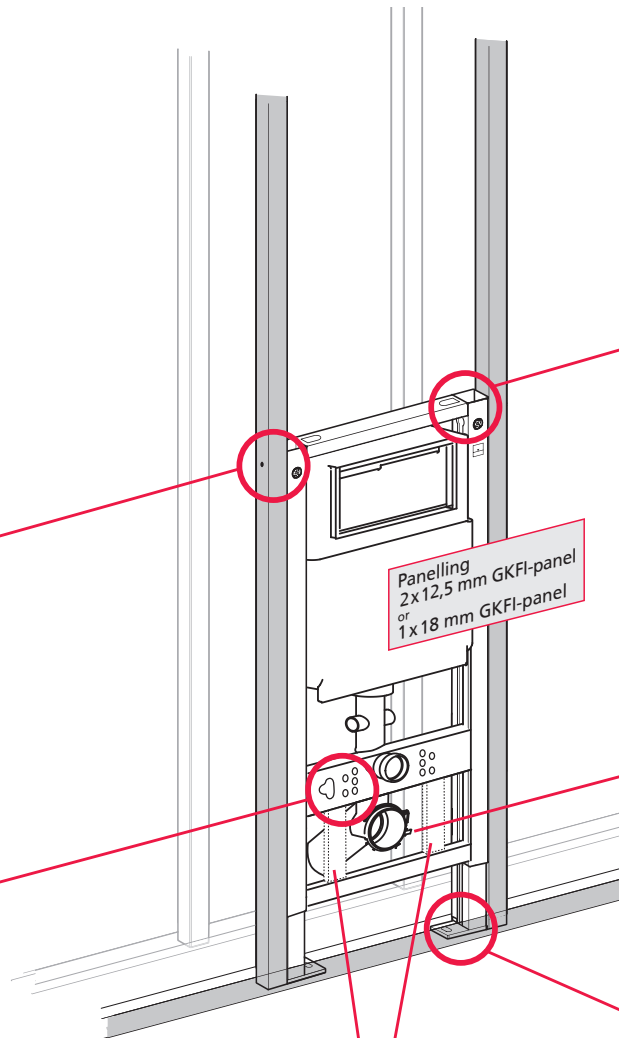

Paneling
2x 12,5 mm GKFI-panel
or
1x 18 mm GKFI-panel

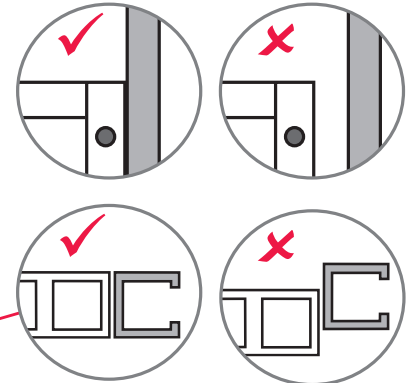

ATTENTION: New clamp mounting

First attach the clamp to the drain pipe, then snap into the abutment

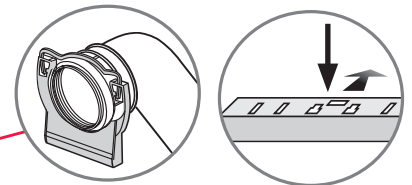

Use a 13 mm spanner to fasten

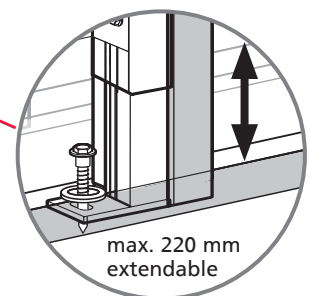

max. 220 mm extendable

Note: Before fitting the element to the corresponding dimensions of the ceramic manufacturer before installation.

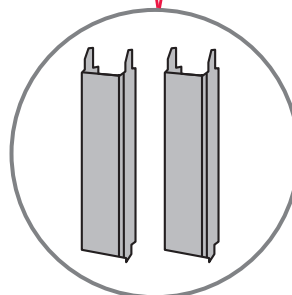

Important note!

WC power bearing for WC ceramics with a support surface smaller than 17 cm, for installation between the traverses item.-no. 216 400

