

# BS+ Bidet Installation instructions

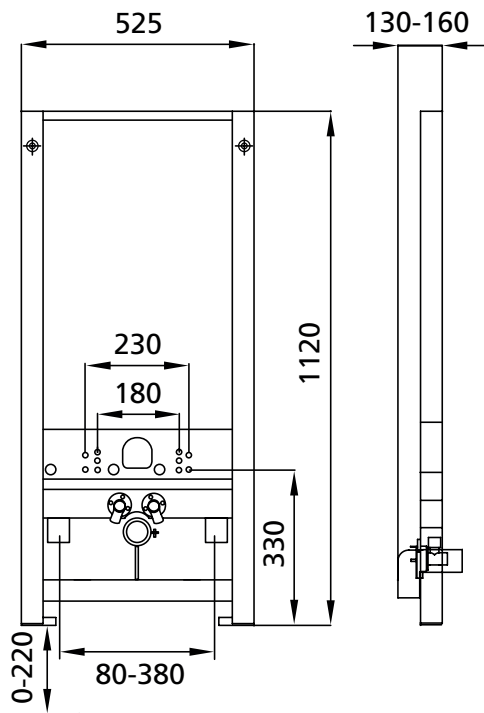

Drill hole spacing when mounting the wall bracket to the outside

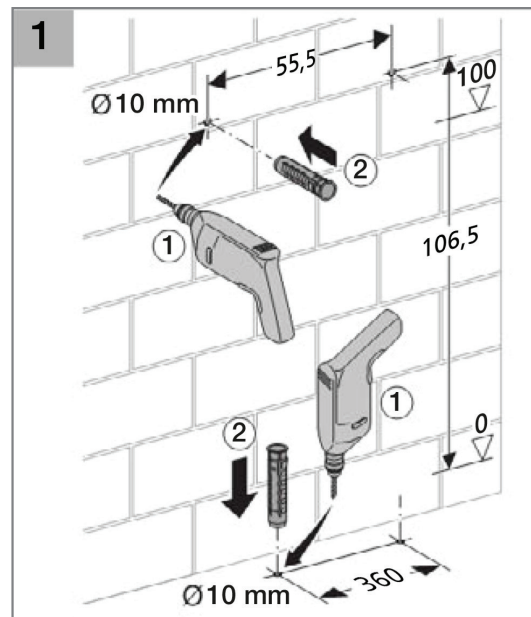

Drill hole spacing when mounting the wall bracket inwards

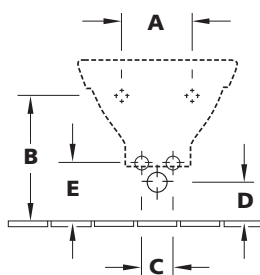
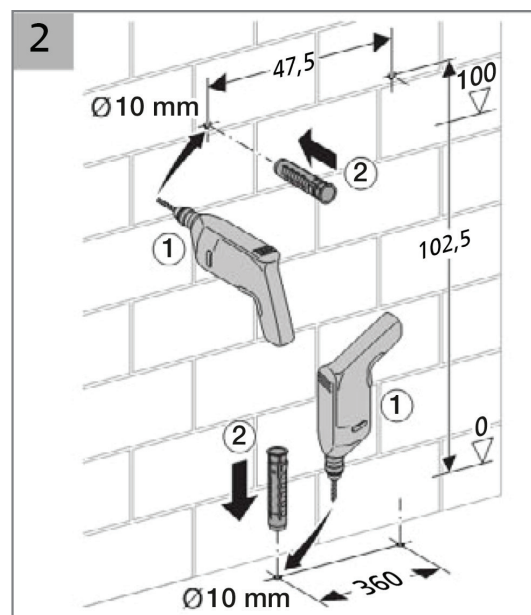

- A Bolt spacing
- B Bolt height
- C Distance angle valves
- D Drain height
- E Angle valve height

**Note:**

Adjustment according to manufacturer's instructions of the bidet used on site. (see page 3)

## Mounting the new wall bracket on the BS+ element

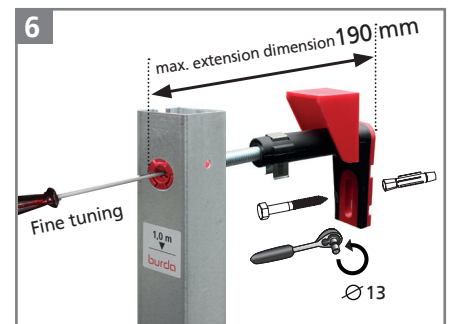
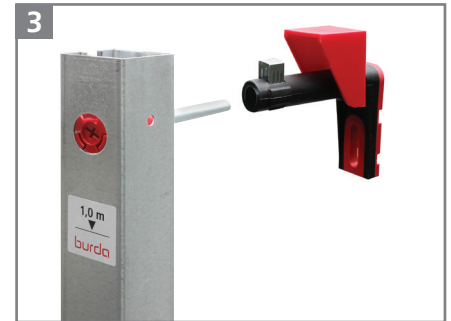
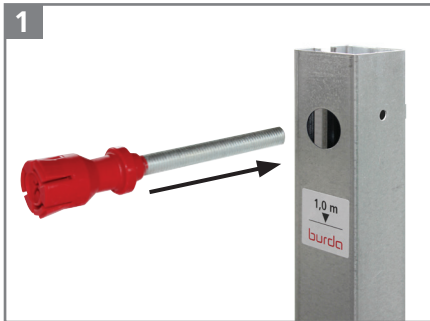

- Push the threaded rod through the drill hole until it clicks
- Push the wall mounting onto the threaded rod, align in depth and fix with the clamp
- Wall bracket with dowels to the wall - Fine adjustment with the screwdriver

## Höhenverstellung der Traversen

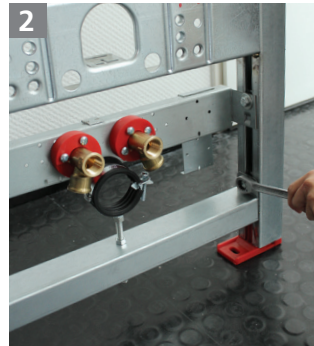
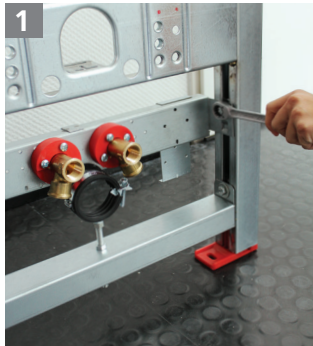

The crossbars must be pre-adjusted to the respective ceramic during unfinished installation, see enclosed fitting list

The bolt height of our bidet elements is set at 330 mm. If ceramic manufacturers specify a lower bolt height, the difference to 330 mm must be added to the angle valve and drain dimensions

It is important to ensure that the distance from the abutment on which the drain sits to the traverse with the angle valves is kept as small as possible, as otherwise the force of

the bidet ceramic cannot be absorbed by the abutment and damage to the tiles cannot be ruled out.

**So please don't just unscrew the threaded rod with the drain, but try to adjust as much as possible via the crossbars.**

See also the instructions on the crossbar. The drain must be locked using two nuts supplied.

## Mounting the bolts

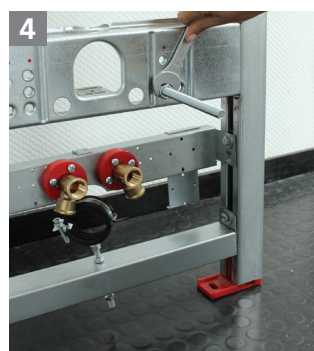
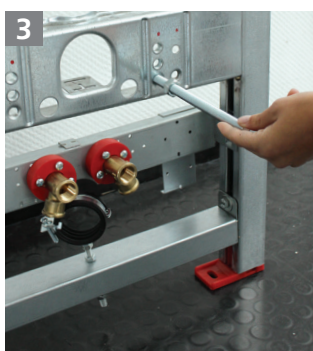

Screw the nut onto the threaded bolt, and then screw it into one of the threaded holes provided. Please note the bolt spacing on the fitting list.

Then lock with a spanner.

### Note

With some ceramics, it may be necessary to mount the supplied clamp in the crossbar from below rather than from above so that the abutment (absorbs the force of the ceramic) is as close as possible to the back of the ceramic. In some installation cases, it may also be necessary to shorten the threaded rod accordingly. These points should be clarified beforehand by looking at the ceramic.

**As the manufacturer, we do not accept any liability for incorrect installation!**

## Mounting on the front wall

To produce the planking support can be installed with UW drywall profiles by simply plugging them on.

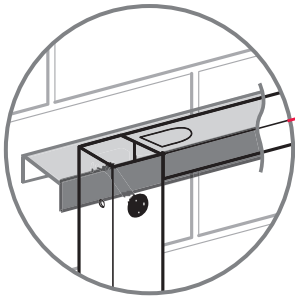

Fastening bolts according to the dimensions of the ceramic manufacturer and lock with the enclosed 12 mm nuts.

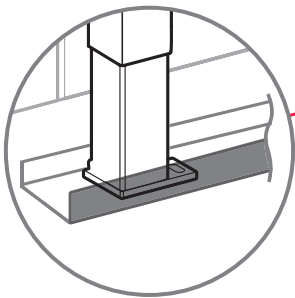
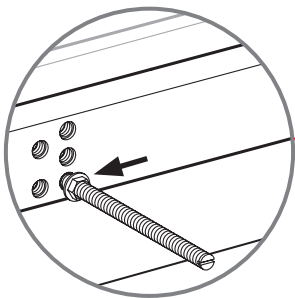

Use of a UW drywall profile as a floor rail facilitates the professional drywall panelling.

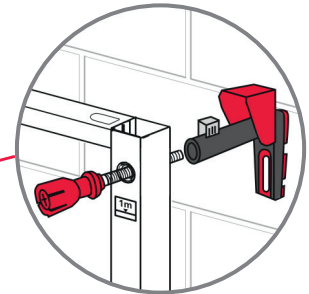
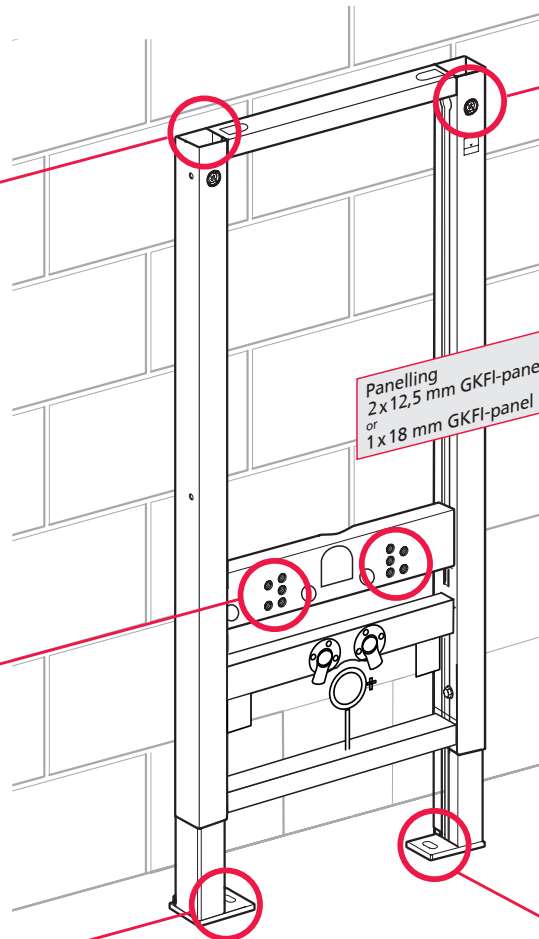

Push the threaded rod through the drill hole into the wall bracket until it clicks, align the depth of the wall bracket and secure with the clamp.

Use a 13 mm spanner to fasten

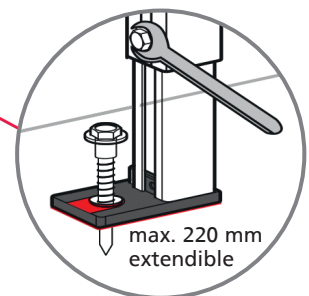

**Please note:** Adjust the element to the corresponding dimensions of the ceramic manufacturer before installation.

## Mounting on the stud wall

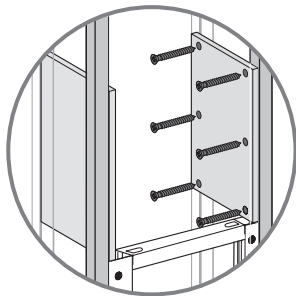

Insert stabilising plates

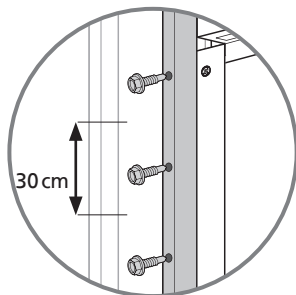

Screw mounting element to vertical drywall profiles.

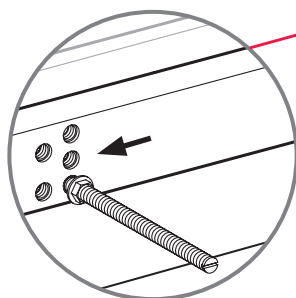

Insert the fastening bolts according to the dimensions of the ceramic manufacturer and lock with the enclosed 12 mm nuts..

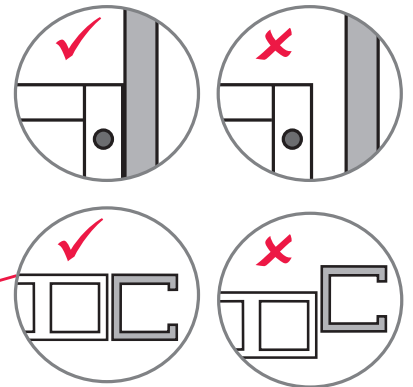
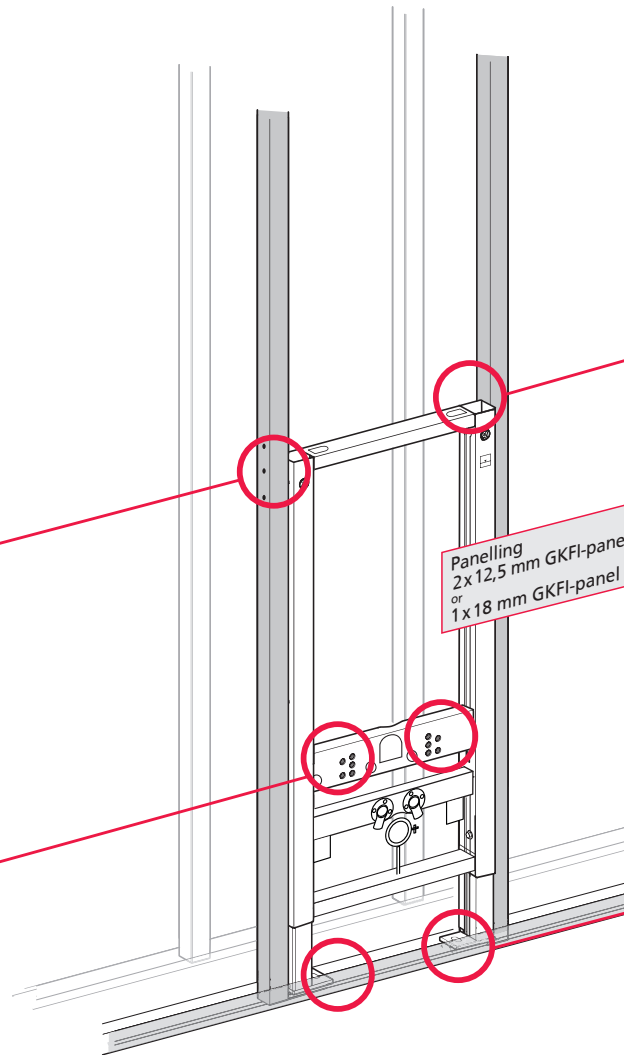

Use a 13 mm spanner to fasten

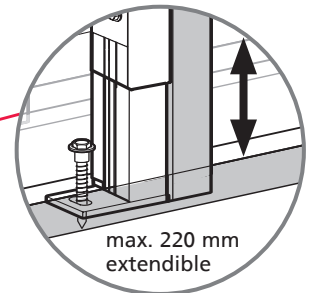

**Please note:** Adjust the element to the corresponding dimensions of the ceramic manufacturer before installation.

